

## General Notes:

- Track lengths are equal to 2x the nominal door width (Example: 36" wide door will have a 72" long track.) See Page 4.
- For Bi-parting doors, two sets of track, 2x the nominal single door width are needed. The tracks can be butted together. See Page 5.
- Track wall spacers are for typical 1-3/4" doors. For doors greater than 1-3/4" thick additional trim board or spacers are required.
- If the door is not a typical size (Example. 40") one or both end stop(s) will have to be relocated. A hole will have to be drilled in the track in the proper position needed. Use a hex bolt to bolt the stop in place.
- This track and hanger system is rated for doors up to 250 lbs.

## Parts List:

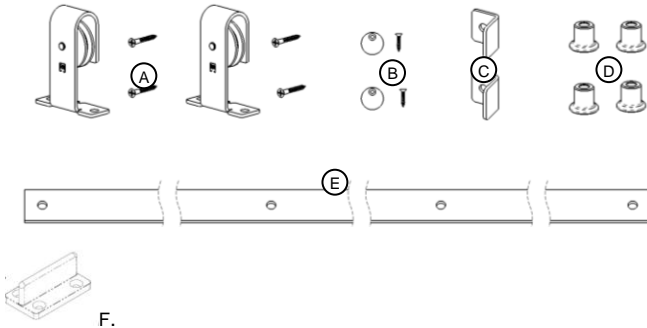

- A. Top mount flat track hangers (pair with hardware)
- B. Anti-jump blocks (2)
- C. End stops (2)
- D. Wall Spacers (qty varies)
- E. Flat track (length varies)
- F. T-Guide

Lag Bolts (not pictured)

## 1. Wall Preparation:

- 1.1. Solid blocking is needed to attach the flat track to the wall, either inside the wall or extended with a head casing on the finished wall.

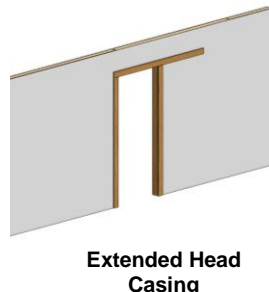

## 2. Door Preparation:

- 2.1. Mortise the Hanger flush with the top and face of the door.

Pre drill for the hangers and anti-jump block.

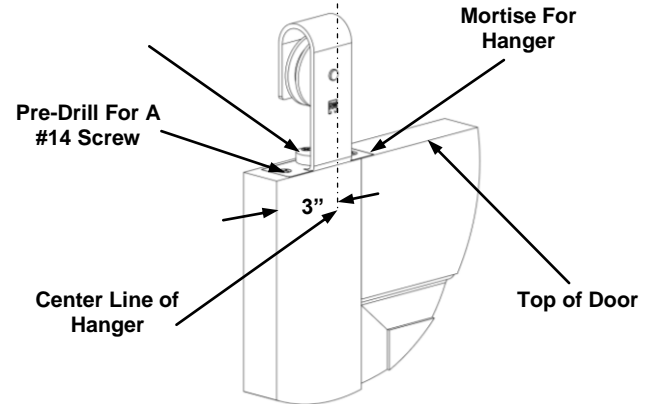

- 2.2. Slot the bottom of the door for the guide. See page 6.

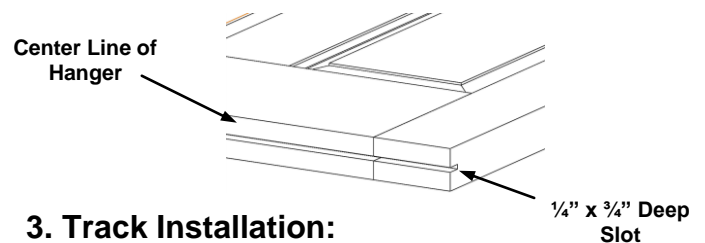

## 3. Track Installation:

- 3.1. The door should overlap opening by 1" on each side (Example: A 36" wide door will have a 34" opening).

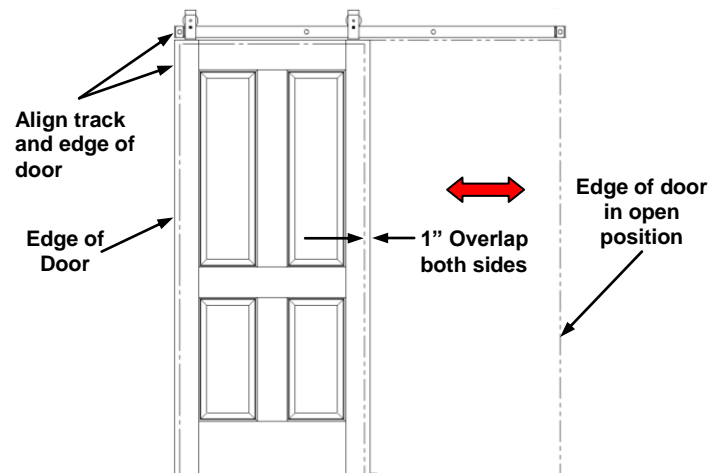

- 3.2. Lay out and mark the location of the holes on the wall. See Flat Track Head Section sheet. The end of the track and the edge of the door should be aligned. (see above)

3.3. Pre drill holes for lag screws.

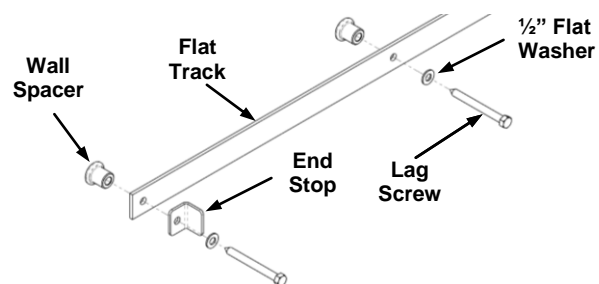

3.4. Hang door on track and mount anti jump blocks.

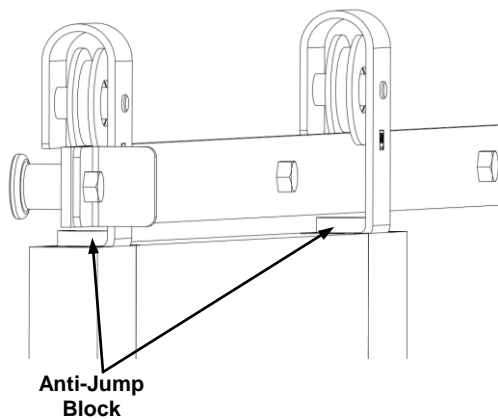

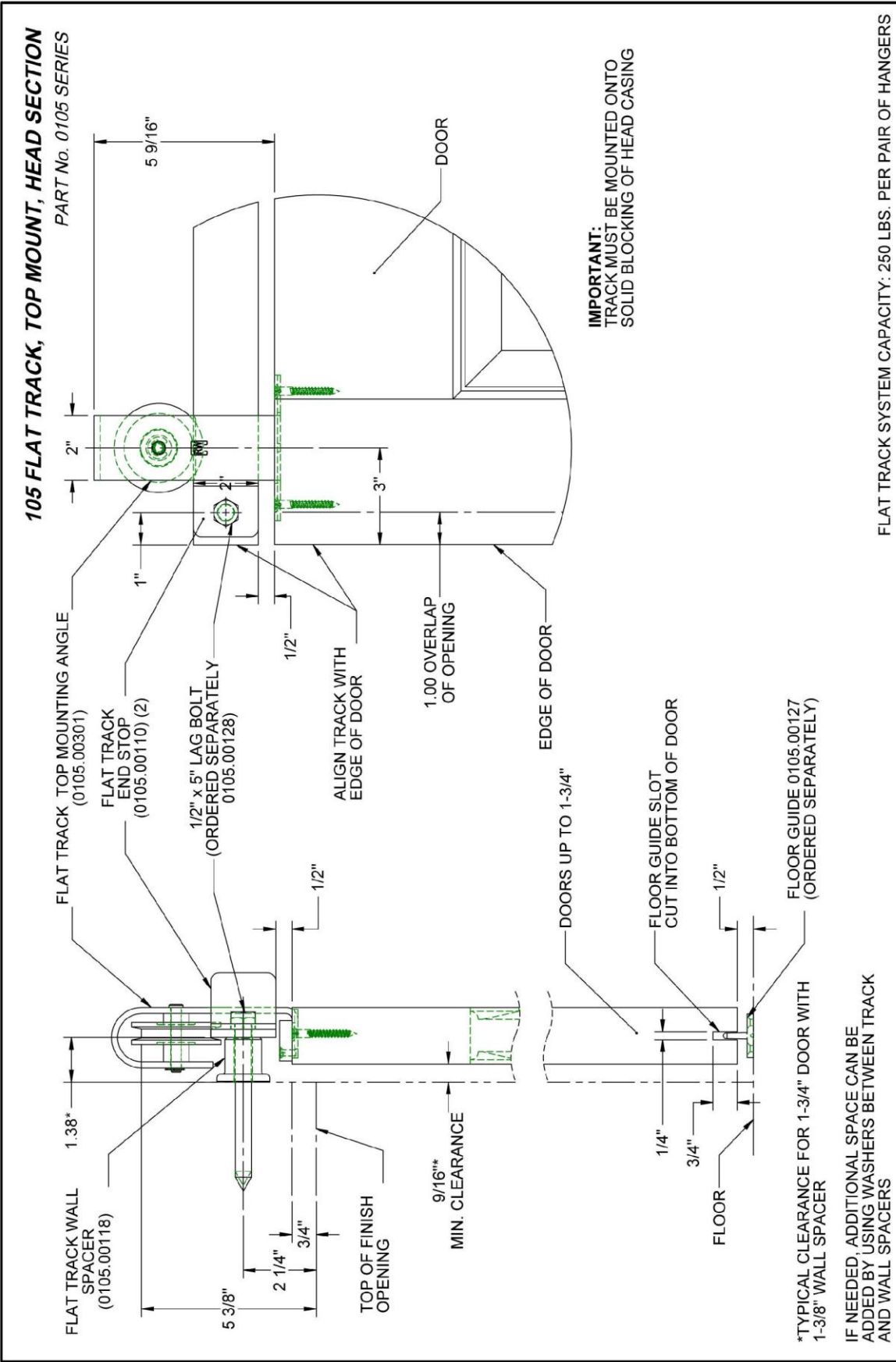

<b>RICHARDS-WILCOX</b> 600 S. Lake St. Aurora, IL 60506 800-253-5668 • (630) 897-6951 richardswilcox.com	DESCRIPTION: 0105 FLAT TRACK, TOP MOUNT, HEAD SECTION			NOTICE: THIS DRAWING IN DESIGN AND DETAIL IS THE PROPERTY OF RICHARDS-WILCOX. ANY REPRODUCTIONS OF THIS PRINT AND/OR DESIGN WITHOUT THE WRITTEN CONSENT OF RICHARDS-WILCOX IS PROHIBITED.	
	Part No.: 0105 SERIES	Date: 8/27/2013	Part Weight: A	Rev.:	

**105 FLAT TRACK, TOP MOUNT, SINGLE DOOR**  
PART No. 0105 SERIES

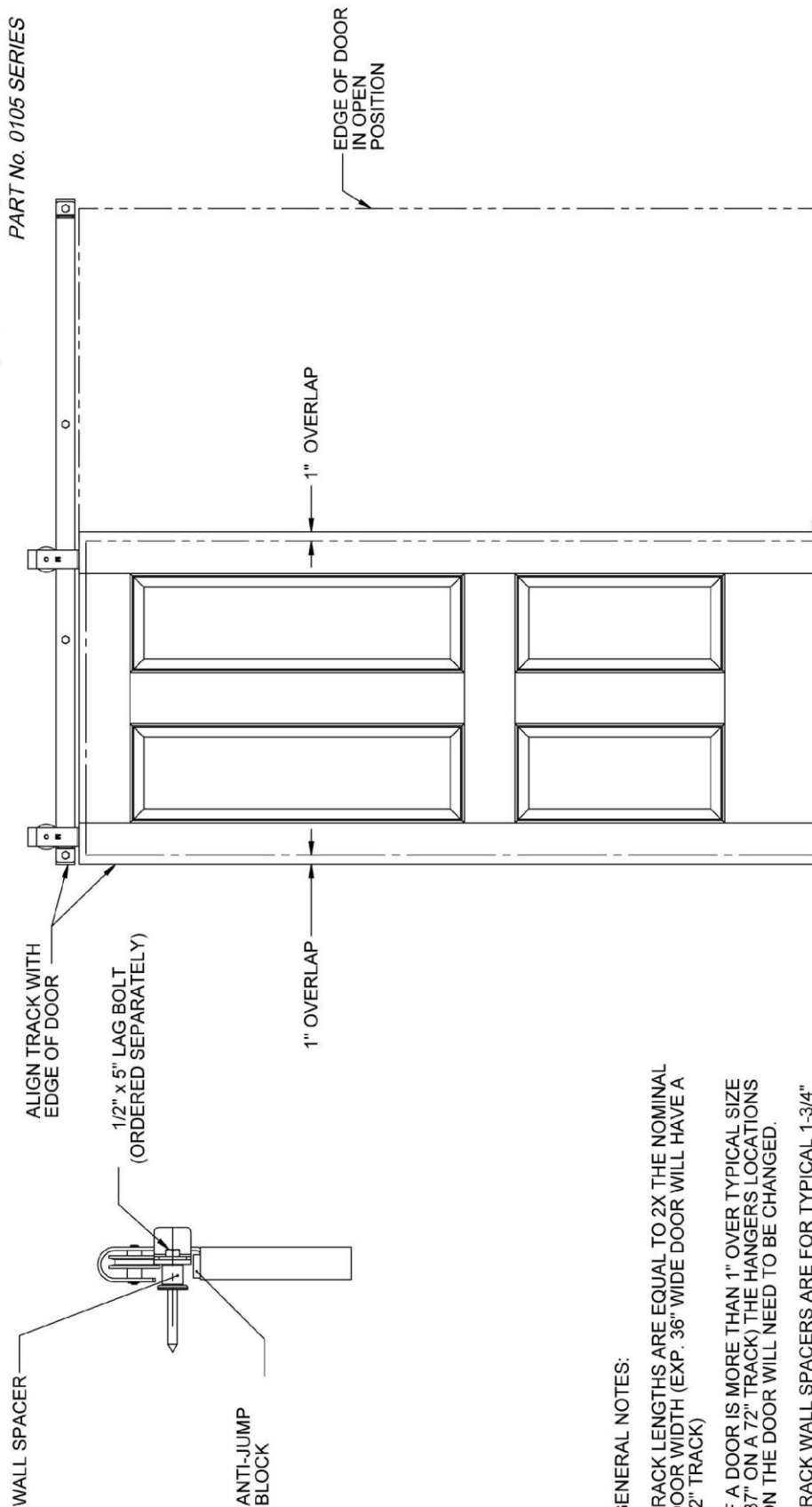

GENERAL NOTES:

TRACK LENGTHS ARE EQUAL TO 2X THE NOMINAL DOOR WIDTH (EXP. 36" WIDE DOOR WILL HAVE A 72" TRACK)

IF A DOOR IS MORE THAN 1" OVER TYPICAL SIZE (37" ON A 72" TRACK) THE HANGERS LOCATIONS ON THE DOOR WILL NEED TO BE CHANGED.

TRACK WALL SPACERS ARE FOR TYPICAL 1-3/4" DOORS. SPACERS FOR 2-1/4" DOORS ARE AVAILABLE AND MUST BE SPECIFIED.

BI-PARTING DOORS, BUTT THE TRACKS ENDS  
TIGHTLY TOGETHER. SPLICE PLATE NOT NEEDED.

**RICHARDS-WILCOX**

600 S. Lake St. Aurora, IL 60506  
800-253-5668 • (630) 897-6951  
richardswilcox.com

FLAT TRACK, TOP MOUNT, SINGLE DOOR

ITEM NO.:	DATE:	REV:	PART WEIGHT:
0105	10/29/12	A	N/A

## NOTICE

THIS DRAWING IN DESIGN AND DETAIL IS THE PROPERTY OF RICHARDS-WILCOX. ANY REPRODUCTIONS OF THIS PRINT AND/OR DESIGN WITHOUT THE WRITTEN CONSENT OF RICHARDS-WILCOX IS PROHIBITED.

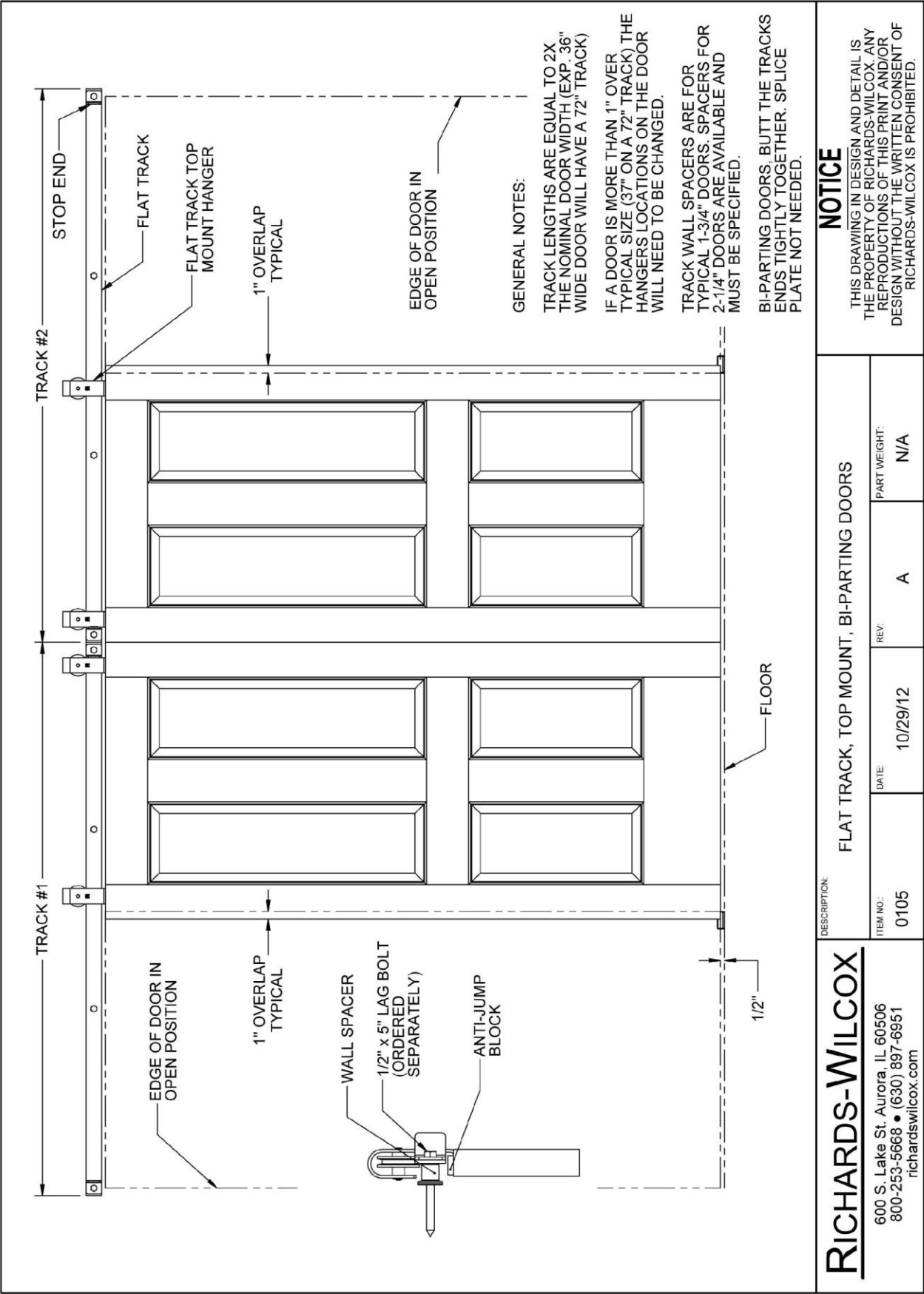

PART No. 0105.00127

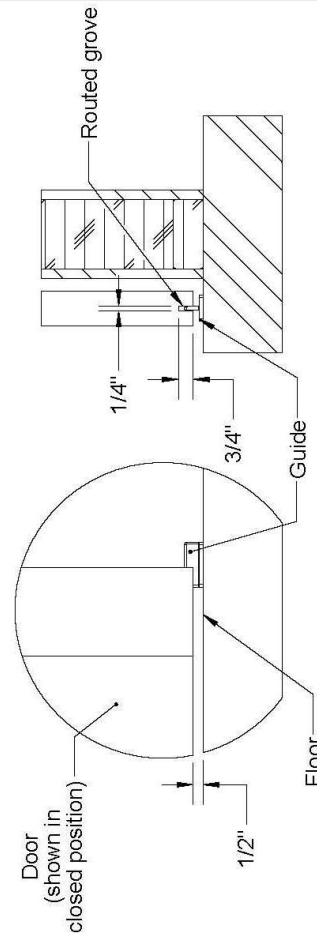
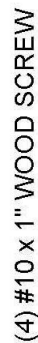

**Application:** Holds the bottom of the sliding door in place to prevent unwanted kick out. A groove needs to be routed in the bottom of the door for the guide.

**Capacity:** 176 lbs. Max door weight

**Finish:** Gray Plastic

**NOTICE:**

**NOTICE:**  
THIS DRAWING IN DESIGN AND DETAIL IS  
THE PROPERTY OF RICHARDS-WILCOX. ANY  
REPRODUCTIONS OF THIS PRINT AND/OR  
DESIGN WITHOUT THE WRITTEN CONSENT OF  
RICHARDS-WILCOX IS PROHIBITED.

<b>RICHARDS-WILCOX</b>		DESCRIPTION:		FLAT TRACK, FLOOR "T" GUIDE	
800 S. Lake St. Aurora, IL 60506 800-253-5668 • (630) 897-6951 richardswilcox.com		Part No.:	0105.00127	Date:	12/12/12
				Part Weight:	0.041
				Rev.:	A